

GKB 1708 Analog Camera

High Resolution Weatherproof Camera with Infrared and Board Lens

GKB 1708 is a compact weatherproof IR camera with board lens. Equipped with Sony Super-HAD CCD II, GKB 1708 presents clear and exquisite picture. The Smart IR LED design could also bring lots of benefits while the object is too close to the camera during night time. Its novel metal housing design provides weatherproof IP 66 rating and for use in outdoor environment.

Features:

- **1/3" Sony Super-HAD CCD II**
Feature with 1/3" Sony Super-HAD CCD II, presents lower lux illumination and clear/crispy picture; ideal for low-lux environment.
- **IR Range 30M**
GKB 1708 features with 64pcs IR LEDs and latest Sony high sensitivity CCD, the IR radiance distance can reach 30m even in outdoor environment.
- **Smart LED Design**
GKB 1708 features a Smart LED Design. While the object too close to the camera, the camera would adjust its current supply to LED for preventing over-exposure problem.
- **Weatherproof Metal Housing**
With a stylish-design weatherproof metal housing, GKB 1708 could fit in most architecture style and install in outdoor environment.
- **Optional Heater**
An optional heater provides wider operation temperature; which allow GKB 1708 working in most severe environment.



Alternate Views



GKB 1708 Analog Camera

Video	Image Sensor	1/3" Sony Super-HAD CCD II
	Effective Number of Pixels	NTSC: 768(H) * 494(V) PAL: 752(H) * 582(V)
	Resolution	550 TVL
	Min. Illumination	0.3Lux (50 IRE, F1.4); 0.01Lux(10 IRE, F1.4)
	Gamma	0.45
	S/N Ratio	>48dB
	Sync. Mode	Internal Sync.
	Scanning System	2:1 Interlace
	Horizontal Sync. Frequency	NTSC: 15.734 KHz / PAL: 15.625 KHz
	Shutter Control	NTSC: 1/60~1/100,000 sec PAL: 1/50~1/100,000 sec
	BNC Video Output	Composite 1.0 Vp-p, 75 ohm
	Night Mode	Auto
	Auto Electronics Shutter	On
	Auto Gain Control	On
	Back Light Compensation	On
White Balance	ATW	
Infrared	Quantity	64pcs
	Peak Wavelength	850nm
	Radiant Distance	30M**
Power	Power Supply	AC 24V/DC (12~24)V; AC (99~240)V
	Power Consumption	Max. 12W
Lens	4.0/6.0/8.0mm Fixed Lens	
Ingress Protection	IP 66	
Dimension	280(L) * 115(Ø) mm	
Weight	1.6 KG	
Operating Temperature	-10°C ~ 60°C	

** Depending on Scene Reflection.

Dimension(mm)

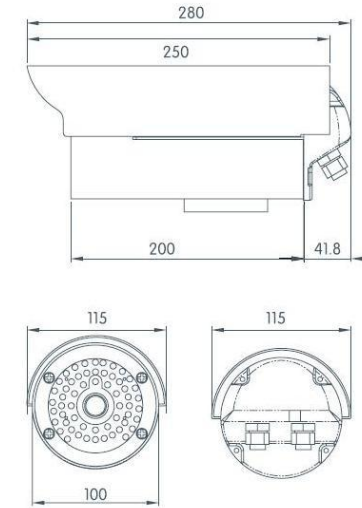

Optional Accessories



HD-914